

260 ✓

John Leavitt to Eph. Poulter Nov 25-1878
 S-298 - Part of N.W. 1/4 Sec 3 T5N R1W,
 Beg. 12.60 ch S, from N.E. cor, S 15.75 ch S 81° W
 19.08 ch N 9.75 ch E, 8.88 ch N, 9.04 ch
 E 9.97 ch to beg.

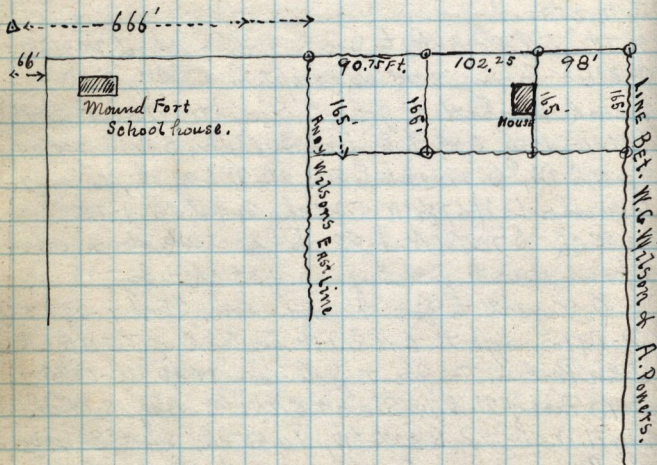

✓
 Copy of deed from James Pennington to - Smith
 of Nashville, Davis Co. Utah,
 Beg. 1.97 ch S. and 1.89 ch W. from N.E. cor, N.W. 1/4
 Sec. 34 T4N R1W, S 17° 36' E, 6.15 ch, to E. line 1/4 Sec.
 S. along said line 12.15 ch, W 13.57 ch, N 32° 5' E
 21.43 ch to beg. 13.38 a.

✓ J. D. Richards, Probate Judge of Nelson Co.
 to James Franklin FEB-14-1873 H-368-
 Lot 13-B-1-Plat B-Huntville Survey
 5.36 a.